

Chifeng University Recording Studio

Brief Acoustical data

Owner: Chifeng University, Chifeng, China
Acoustical Consultant: YP Hadi Sumoro K & Xian Yu

General Information

Chifeng University recording studio is a part of the University's Music Production department. The Recording studio is intensively used for school program and also opens for public.

Architectural and Structural Details

Walls: Brick wall, drywall. Ceiling: Drywall. Floor: Wood parquet. Total Area: $\pm 60\text{m}^2$. Height: $\pm 2.8\text{m}$.

Acoustical Data and Design Information

Control Room Reverberation time: 0.23s (500Hz – 4000Hz).

Reflection Free Zone design on the control room.

Note: Additional measurements and information can be found on the next page.

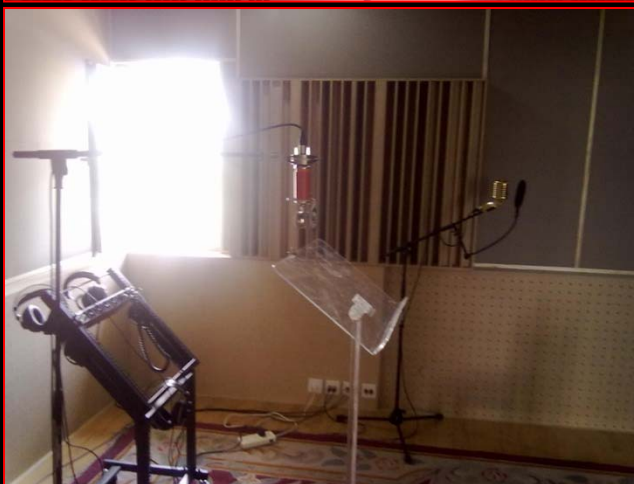
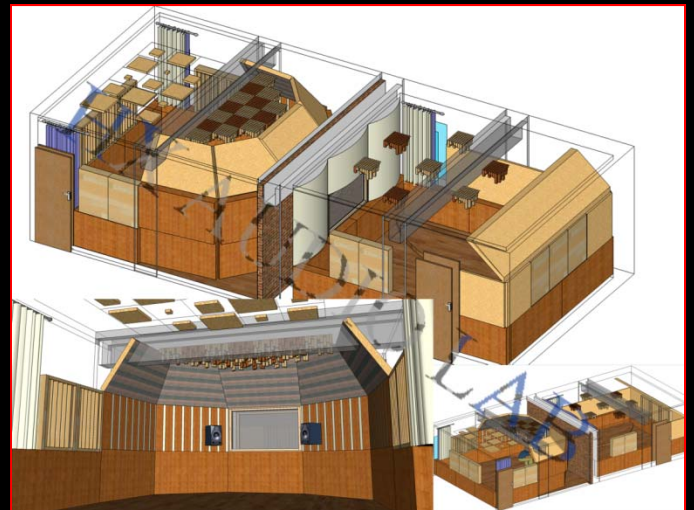
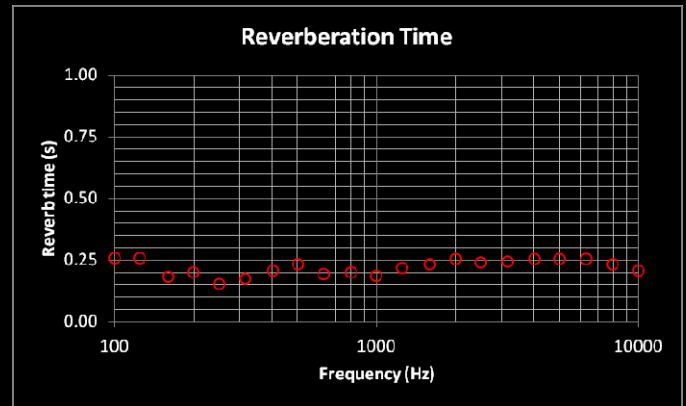

Chifeng University Recording Studio

Brief Acoustical data

All measurements were performed by placing the microphone in the sweetspot (ear height – seated position). ADAM A7 loudspeakers as main reference monitors and Rode Classic II were used to collect impulse responses using two linear sweeps. To achieve high frequency resolution, measurements are divided into two frequency range, 20Hz – 500Hz and 200Hz – 20000Hz. Envelope time curve of the control room can be seen below.

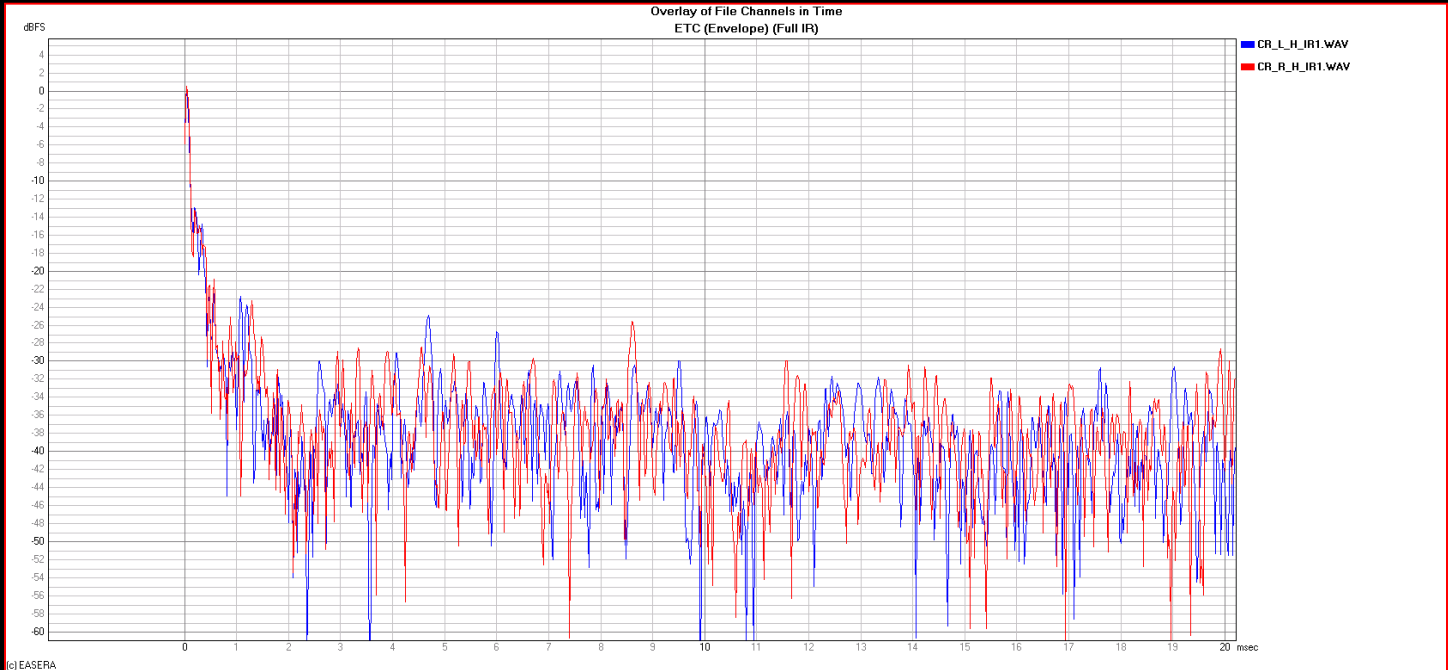

ETC for 200Hz – 20000Hz range

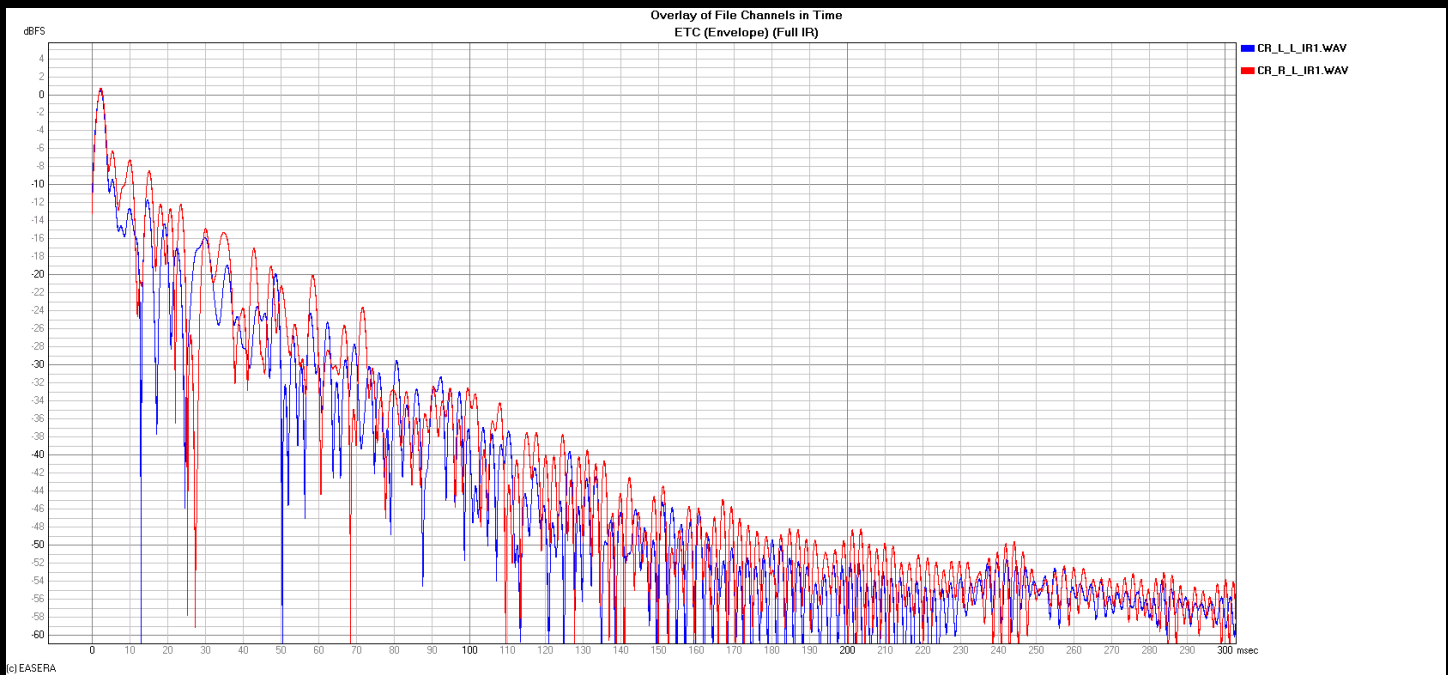

ETC for 20Hz – 500Hz range